



Vacuum Ovens VO101

Digital pressure control ensures rapid and gentle vacuum drying, its speed-controlled vacuum pump (accessory) saves around 70% energy.



The direct contact between the load and the heatable and removable thermoshelves in the chamber of the Memmert vacuum oven VO ensures rapid and uniform temperature control of food, cosmetics, watches, books, PCBs or injection moulds, without the loss of heat.

On this page, you can find all the essential technical data on our vacuum drying oven. Our customer relations team will be pleased to help if you want further information. If you should require a customised special solution, please contact our technical specialists at myAtmoSAFE@memmert.com.

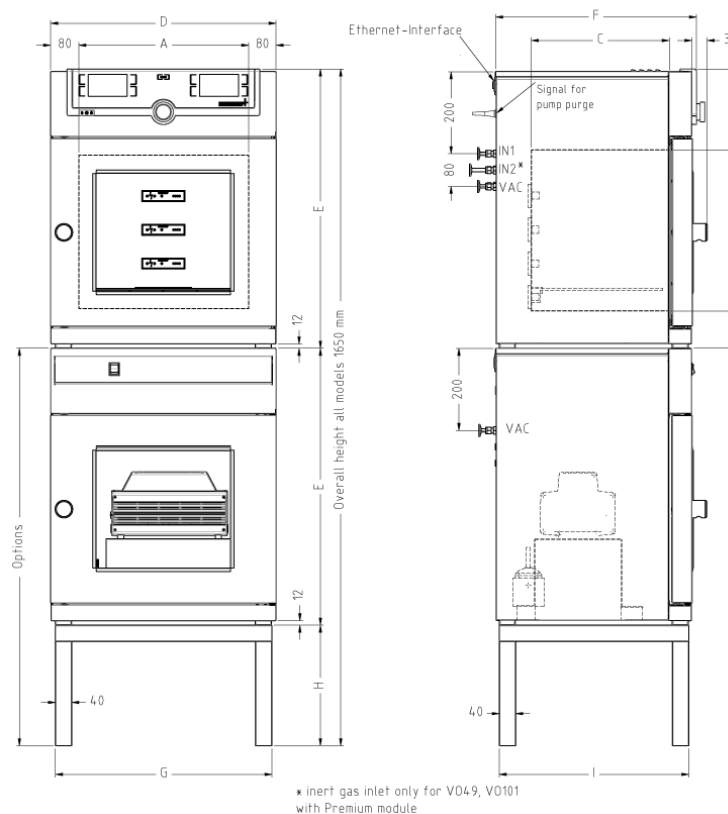

Temperature

Temperature temperature measured through 4-wire Pt100 sensor individually for each thermoshelf

Working temperature range min. 5°C above ambient up to +200°C

Setting accuracy temperature 0.1 °C

Pressure (Vacuum)

Vacuum range 5 to 1100 mbar

Pressure control Digital electronic pressure control for a speed-controlled vacuum pump. Tubing for vacuum, air and inert gas are made of material 1.4571 (ASTM 316 Ti). Programmable, digitally controlled inlet for air.

Permitted final vacuum 0.01 mbar

Maximum leakage rate 0.01 bar/h

Pump control speed control, optimised rinsing procedures for the pump membranes as well as signal output for pump ON/OFF

Connection Vacuum connection with small flange DN16, and gas inlet with small flange DN16

Control technology

adjustable parameters temperature (Celsius or Fahrenheit), pressure (vacuum), programme time, time zones, summertime/wintertime

Language setting German, English, Spanish, French, Polish, Czech, Hungarian, Italian

ControlCOCKPIT TwinDISPLAY. Adaptive multifunctional digital PID-microprocessor controller with 2 high-definition TFT-colour displays.

Timer Digital backwards counter with target time setting, adjustable from 1 minute to 99 days

Function SetpointWAIT the process time does not start until the set temperature is reached

Communication

Interface Ethernet LAN, USB

Documentation programme stored in case of power failure

Programming AtmoCONTROL software on a USB stick for programming, managing and transferring programmes via Ethernet interface or USB port

Safety

Temperature control mechanical temperature limiter TB, protection class 1 according to DIN 12880 to switch off the heating approx. 10°C above nominal temperature

AutoSAFETY additionally integrated over- and undertemperature protection "ASF", automatically following the setpoint value at a preset tolerance range, alarm in case of over- or undertemperature, heating is switched off in case of overtemperature, compressor in case of undertemperature

Autodiagnostic system integral fault diagnostics for temperature control

Alarm visual and acoustic

Heating concept

VO direct heating	fuzzy-supported MLC (Multi-Level-Controlling) microprocessor controller adapting its performance to the volume (local temperature sensing) for each thermoshelf
Thermoshelves	2 connections for thermoshelves in the rear (1st and 3rd level)

Standard equipment

Works calibration certificate	for +160°C at 20 mbar pressure for each supplied thermoshelf together with the vacuum oven
Internals	1 thermoshelf of aluminum, material 3.3547 (ASTM B209) with integrated large-area heating

Stainless steel interior

Material	hermetically welded stainless steel interior of extremely corrosion-resistant stainless steel, material 1.4404
Interior	additional interior mountings of stainless steel, material 1.4404 (removable for cleaning), consisting of mounting at the sides with guide bars for thermoshelves and on top (diffusor) to avoid turbulences when aerating
Volume	101 l
Dimensions	$w_{(A)} \times h_{(B)} \times d_{(C)}$: 545 x 465 x 400 mm
Max. number of internals	2
Max. loading of chamber	60 kg
Max. loading per internal	20 kg

Textured stainless steel casing

Door	full-sight glass door, inside spring-loaded, 15 mm thick glazed panel in safety glass, outside with anti-splitter screen
Dimensions	$w_{(D)} \times h_{(E)} \times d_{(F)}$: 710 x 767 x 550 mm
Housing	rear zinc-plated steel

Electrical data

Voltage	230 V, 50/60 Hz
Electrical load	approx. 1220 W

Ambient conditions

Ambient temperature	+5 °C to +40 °C
Set Up	The distance between the wall and the rear of the chamber must be at least 15 cm. The clearance from the ceiling must not be less than 20 cm and the side clearance from the wall must not be less than 8 cm.
Humidity rh	max. 80 %, non-condensing
Overvoltage category	II
Pollution degree	2

Packing/shipping data

Transport information	The appliances must be transported upright
Customs tariff number	8419 8998
Country of origin	Federal Republic of Germany
WEEE-Reg.-No.	DE 66812464
Dimensions approx incl. carton	w x h x d: 820 x 970 x 670 mm
Net weight	approx. 110 kg
Gross weight carton	approx. 135 kg

Standard units are safety-approved and bear the test marks

